



## INTERLOC LOCKER TYPE

# INTERLOC TOWEL BIN - PORT HOLE

### TOWEL BIN AND SHELVING UNIT. PORT HOLE DESIGN. TOWEL STORAGE.

- ▶ Towel Unit- Port Hole
- ▶ 1800mm high x 600mm deep (standard)
- ▶ 400mm wide standard
- ▶ Custom dimensions available upon request
- ▶ Interloc Plinth 110mm high black (standard)
- ▶ Coloured plinth available upon request
- ▶ Or Custom height (Interloc recommend no lower than 80mm)
- ▶ Bulkheads available
- ▶ End Panels / Filler Panels to suit
- ▶ Sloping Tops Optional

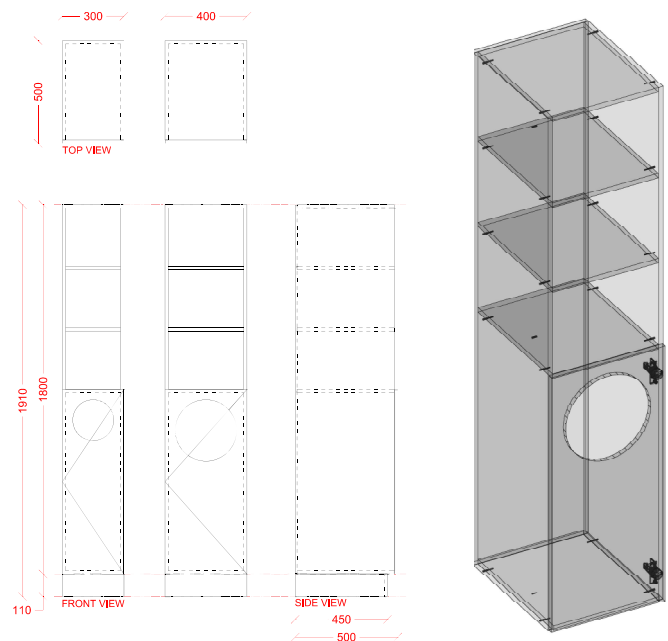

**REVIT Portal**  
[portal.interloc.com.au](http://portal.interloc.com.au)

**Locker Builder**  
(separate to Revit)